

STANDARD TRIUMPH RENOWN SPARE PARTS LIST

Ref. No.	Part No.	Description	No. Off	Remarks
WATER PUMP				
	501110	Water pump assembly	1	
29	57014	Body only, water pump	1	
	56243	Stud, in pump body	2	
30	57216	Plug, in pump body	1	Not required when heater fitted.
	200287	Bearing housing only	1	
23	106096	Fan and water pump bearing housing assembly ...	1	
16	100763	Snap ring, fitted in bearing housing	1	
17	100978	Bearing, fitted on spindle	2	
19	60313	Seal, for bearing	1	
22	105982	Spindle	1	
18	100760	Distance piece, on spindle	1	
26	100858	Seal, water pump	1	
28	105981	Impellor	1	
20	500047	Circlip, fitted on spindle	1	
21	101092	Abutment washer, fitted on spindle	1	
	500051	Bolt, impellor to bearing	1	
	500052	Nut, impellor to bearing	1	
	WL0205	Spring washer, impellor to bearing	1	
24	56214	Gasket, water pump housing to body	1	
	NH2009	Nut, water pump housing to body	2	
	WL0209	Spring washer, water pump housing to body ...	2	
31	56237	Gasket, pump to cylinder block	1	
	BH0968	Bolt, pump to cylinder block	2	
	BH0971	Bolt, pump to cylinder block	1	
	WL0209	Spring washer, pump to cylinder block	3	
25	56939	Grease nipple	1	
14	101362	Fan pulley, and extension	1	

STANDARD TRIUMPH RENOWN SPARE PARTS LIST

Ref. No.	Part No.	Description	No. Off	Remarks
WATER PUMP (contd.)				
12	200826	Fan assembly	1	For all replacements.
11	38665	Balance piece, for blades	as req.	
	BH0756	Bolt, pulley attachment	4	
	WL0207	Spring washer, pulley attachment	4	
15	200288	Fan belt	1	
13	57810	Cotter, for pulley to bearing	1	
	101146	Cotter, for pulley to bearing	1	
	100766	Washer	1	
	NH2008	Nut, cotter to bearing	1	
	WL0208	Spring washer, cotter to bearing	1	
	NN2908	Simmonds nyloc nut	1	
DYNAMO MOUNTING				
36	101235	Dynamo bracket	1	
37	59015	Dynamo pedestal	1	
	NT3211	Nut, thin nyloc, pedestal to bracket	1	
	BH0856	Bolt, bracket to cylinder block...	3	
	WL0208	Spring washer, bracket to cylinder block	3	
32	102266	Pulley, on dynamo	1	
	102267	Dynamo fan	1	
	BH0808	Bolt, rear of bracket	1	
	NT3208	Nut, thin nyloc, rear of bracket	1	
	59115	Bolt, front of bracket	1	
	WP0017	Washer, front of bracket	1	
	WL0208	Spring washer, front and rear of bracket	2	
38	101056	Adjusting link, to pump	1	
	BH0857	Bolt, adjusting link to pump	1	
	WL0208	Spring washer, adjusting link to pump	1	

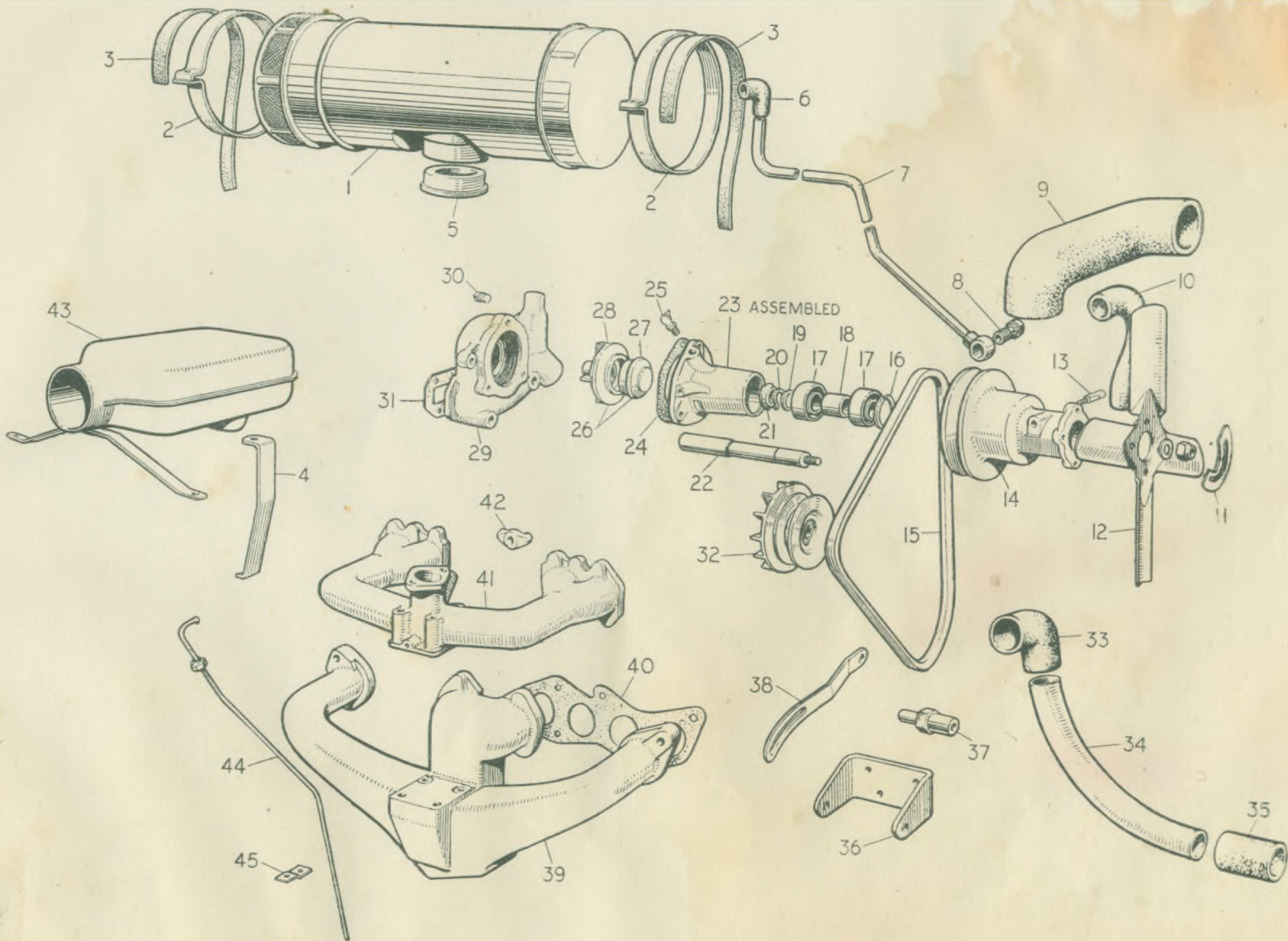

STANDARD TRIUMPH RENOWN SPARE PARTS LIST

Ref. No.	Part No.	Description	No. Off	Remarks
MANIFOLD DETAILS				
Fitted from Comm. No. TDB IE to TDB 5094E only.				
39	59505	Exhaust manifold	1	
	V7335	Stud, inlet manifold, outer	2	
	58927	Stud, inlet manifold, inner	2	
	101442	Stud, exhaust outlet	4	
41	60973	Inlet manifold	1	
	60402	Stud, carburettor attachment	2	
	NH2008	Nut, inlet to exhaust	4	
	WL0208	Spring washer, inlet to exhaust	4	
MANIFOLD DETAILS				
Fitted from Comm. No. TDB 5095E and future				
	102312	Exhaust manifold assembly	1	
		comprising		
39	300476	Exhaust manifold	1	
	102311	Bush, flap valve	2	
	102357	Spindle, flap valve	1	
	102309	Flap valve	1	
	101796	Stop peg	1	
	500410	Spring anchorage pin	1	
	101979	Stud, inlet manifold, inner and outer	4	
	101442	Stud, exhaust outlet	4	
	102765	Bi-metal spring, fitted on flap valve spindle	1	
	102374	Balance weight, fitted on flap valve spindle	1	
	102360	Spring stop, fitted outside spring	1	
	500411	Mills pin, fitted on balance weight end and spindle	1	
	PC0043	Cotter pin, fitted on flap valve spindle	1	

STANDARD TRIUMPH RENOWN SPARE PARTS LIST

Ref. No.	Part No.	Description	No. Off	Remarks
MANIFOLD DETAILS (contd.)				
Fitted from Comm. No. TDB 5095E and future				
41	300474	Inlet manifold	1	
	46172	Core plug , fitted in inlet manifold	2	
	60402	Stud , fitted in inlet manifold	2	
	103241	Manifold joint	1	
	WL0208	Spring washer , inlet to exhaust manifold	4	
	NH2008	Nut , inlet to exhaust manifold	4	
MANIFOLD DETAILS				
	58685	Union , for drain pipe	1	
	500053	Washer , for drain pipe	1	
44	101288	Drain pipe assembly	1	Comm. No. TDB 1 to TDB 5094 only.
	200668	Drain pipe assembly	1	Comm. No. TDB 5095 and future.
45	42906	Clip , drain pipe, fitted on sump set screw	1	
40	60256	Washer , manifold	2	
42	58258	Clamp , manifold	6	8 off up to TDB 5094 only.
	56675	Nut , manifold to combustion head	8	10 off up to TDB 5094 only.
	WL0209	Spring washer , manifold to combustion head	10	
	58682	Stud , manifold, intermediate	2	6 off up to TDB 5094 only.
	58688	Stud , manifold, outer	4	2 off up to TDB 5094 only.
	58917	Stud , manifold, centre, lower	2	
	57924	Washer , pipe to manifold	1	
	60651	Nut , pipe to manifold	4	
	WL0209	Spring washer , pipe to manifold	4	

STANDARD TRIUMPH RENOWN SPARE PARTS LIST

Ref. No.	Part No.	Description	No. Off	Remarks
BREATHER DETAILS				
60966		Washer , for vent valve fitted in inlet manifold	1	Comm. No. TDB 1 to TDB 6469 only.
60901		Pin , fitted in washer 60966	1	Comm. No. TDB 1 to TDB 6469 only.
60900		Sleeve , connecting tube and washer to manifold	1	Comm. No. TDB 1 to TDB 6469 only.
60899		Nut , connecting tube and washer to manifold	1	Comm. No. TDB 1 to TDB 5094 only.
60897		Connecting tube assembly , manifold to rocker cover	1	Comm. No. TDB 1 to TDB 5094 only.
60899		Nut , connecting tube and washer to manifold	1	Comm. No. TDB 5095 and future.
102376		Connecting tube assembly , manifold to rocker cover	1	Comm. No. TDB 5095 and future.
103816		Breather assembly	1	Comm. No. TDB 6470 and future.
103817		Union screw	1	Comm. No. TDB 6470 and future.
103818		Breather screw	1	Comm. No. TBD 6470 and future.
103819		Pin , for breather	1	Comm. No. TDB 6470 and future.
103950		Distance piece , fitted to manifold	1	Comm. No. TDB 6470 and future.
THERMOSTAT DETAILS				
100802		Thermostat assembly	1	Comm. No. TDB 2000 only.
101570		Thermostat assembly	1	Comm. No. TDB 2001 and future.
101463		Thermostat body	1	Comm. No. TDB 2001 and future.
101464		Thermostat unit	1	Comm. No. TDB 2001 and future.
60749		Union , in thermostat	1	
101478		Gasket , thermostat to cylinder head	1	
WF0524		Washer , for union	1	
36999		Washer , for thermostat	1	
101569		Water elbow	1	
57103		Gasket , elbow to housing	1	
BH0809		Bolt , elbow to housing	2	
NH2008		Nut , elbow to housing	2	
WL0208		Spring washer , elbow to housing	2	

STANDARD TRIUMPH RENOWN SPARE PARTS LIST

Ref. No.	Part No.	Description	No. Off	Remarks
HOSE AND WATER CONNECTION				
10	59029	By-pass hose	1	
	CS4018	Hose clip, by-pass hose	2	
	100949	Radiator hose, top, radiator to thermostat	1	Comm. No. TDB 1 to TDB 2000 only.
9	101571	Radiator hose, top, radiator to thermostat	1	Comm. No. TDB 2001 and future.
	CS4041	Hose clip, top hose to thermostat	2	
33	58180	Hose, top, pump to pipe	1	
	CS4028	Hose clip, pump to pipe and pipe to radiator	4	
34	100195	Pipe, bottom, steel	1	
35	58180	Hose, bottom, pipe to radiator	1	
CARBURETTOR CONTROL				
	60273	Bracket, cable control	1	Comm. No. TDB 1 to TDB 5094 only.
	102460	Bracket, cable control	1	Comm. No. TDB 5095 and future.
	48008	Clip, for cable to bracket	1	
	TR6504	Domed head screw, to bracket	1	
	NH2005	Nut, to bracket	1	
	WL0205	Spring washer, to bracket	1	
	60272	Tab washer, carburettor return spring	1	Comm. No. TDB 1 to TDB 5094 only.
	102380	Tab washer, carburettor return spring	1	Comm. No. TDB 5095 and future.
	60274	Throttle spring	1	

STANDARD TRIUMPH RENOWN SPARE PARTS LIST

Ref. No.	Part No.	Description	No. Off	Remarks
AIR SILENCER				
1	59479	Air silencer...	1	
5	59481	Rubber grommet, silencer to carburettor	1	
2	60731	Clip, air silencer	2	
3	59482	Packing, silencer	2	
	UH0810	Set screw, silencer to rocker cover	2	
	NH2008	Nut, silencer to rocker cover	2	
	WL0208	Spring washer, silencer to rocker cover	2	
43	60725	Air cleaner pipe assembly	1	Comm. No. TDB 1 to TDB 5094 only.
	200483	Air cleaner pipe assembly	1	
	NH2008	Nut, upper to lower bracket	2	
	WL0208	Spring washer, upper to lower bracket	2	
	60767	Hose, air cleaner	1	
	CS4051	Pipe clip	2	
4	100692	Bracket, air silencer	1	Comm. No. TDB 1 to TDB 5094 only.
	102470	Bracket, air silencer	1	
	BH0704	Bolt, bracket to pipe	1	
	WL0207	Spring washer, bracket to pipe	1	
	WP0007	Washer, bracket to pipe	1	
6	59543	Hose, pipe to cleaner	1	
	CS4012	Clip, pipe to cleaner	2	
	60261	Clip, pipe to condenser bracket	1	
	BH0703	Bolt, to condenser bracket	1	
	NH2007	Nut, to condenser bracket	1	
	WL0207	Spring washer, pipe to condenser bracket	1	
7	60766	Pipe, air cleaner to cylinder block	1	
8	57658	Screw union, pipe to cylinder block	1	
	WF0512	Fibre washer, small, cylinder block	1	
	WF0524	Fibre washer, large, cylinder block	1	